



## **WL-20K Medium Intensity Aviation Obstruction Light**

### **Instruction Manual**

Rev: 2.0V

## **Descriptions**

WL-20K Medium intensity obstruction light for daytime and nighttime marking Towers (Telecom, GSM), Smokestacks, Buildings and any other potentially hazardous obstructions to air traffic with a flashing white safety light. It is compliant to the ICAO standard.

The enclosure is made of die casting aluminum with powder coated finish, light weight, waterproof, shockproof and corrosion resistant. Self-contained wiring compartment makes the product ease of mount. Light source consists of external long life LEDs, to ensure maximum life of the product.

The most important feature of WL-20K is that it works as a dual light. At day time the LED arrays are working and omitting 20,000cd light intensity and at night time using the integrated change-over relay, the LED array will work to omit a light output intensity of 2,000cd.



❖ *Above: The “WL-20K” White Medium Intensity Aircraft Warning Light*

## **Main functions and features**

- Modular design and meets optics standard, compact size and high efficiency
- Based on LED technology
- Extremely Reliable - Major Maintenance Cost Saving
- Resistant to Shock and Vibrations
- Lamp housing –Polycarbonate, with good anti-impact strength, thermal stability, high transmittance
- Self-contained wiring compartment - eliminates additional boxes
- Base material--Die casting aluminum LM6 alloy
- Reflector - ABS
- Combustibility rating : UL94-V0
- IP protection : IP65
- Operating temperature: -30°C - +60°C, can withstand the most severe environments
- Flashing LED type
- Typical LED lifetime: ≥100, 000 hrs
- GPS synchronization between 2 or more Delta lights (please ask Delta sales/technical for further information)
- All LED's are connected in parallel, which are powered by low voltage, constant current; when and if one fails it will not affect the other LED's.

## **Specifications**

- Compliant to ICAO Standard (Annex 14) Type A and FAA standard L865
- Operating voltage: AC110V-240V (DC also available upon request)
- Power Frequency: 50Hz ~ 60Hz
- Power consumption: 100W at day mode  
10W at night mode
- Intensity: 20,000cd  $\pm$  25%
- Horizontal degree: 360°
- Vertical degree: 3°mnm
- Aviation white colour, (Type A medium intensity)
- LED life: >100,000 hrs
- Visible distance: >16.5Km (AT = 0.85)
- Flashing rate: 20fpm
- IP Protection: IP65
- Weight: 15Kg (approx)
- Dimension : 300mm(Dia) ; 335mm(H)

**Installation**

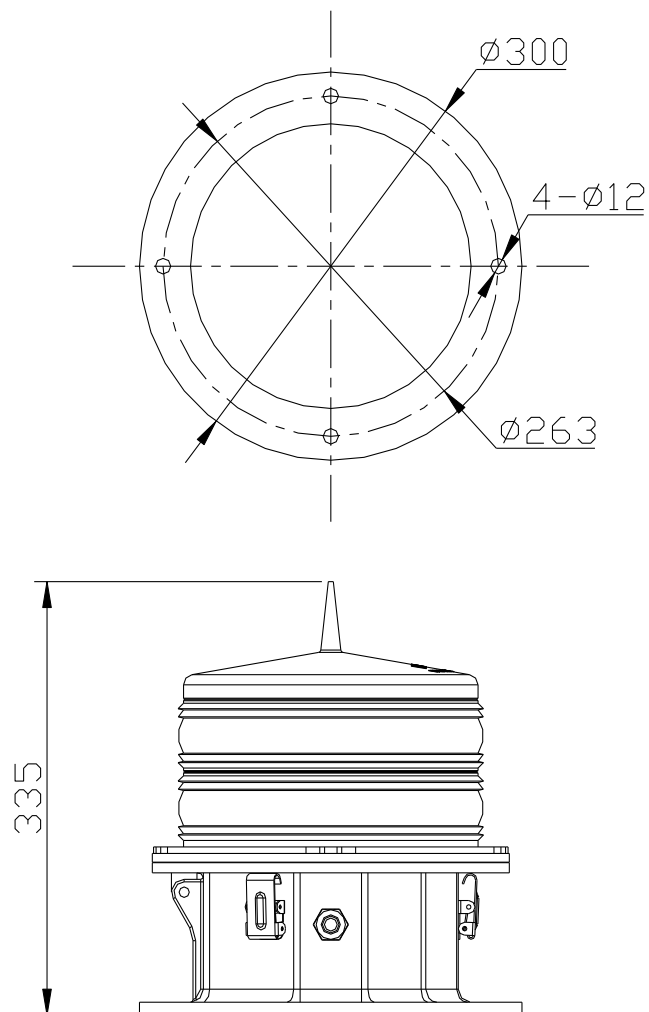

## Wiring

- Secure the light on a smooth surface which has enough strength, if there is no mounting surface, we can customize special mounting bracket as request.
- When installing, please keep away from any nearby light source, at the same time, ensure the photocell (if installed) will not covered the light unit and/or light beam.
- Make sure the power supply can match the rated power of light before connecting.
- Unfasten the 3 clips on the neck of the light unit and overturn the lamp head, you can now see the connection terminals.

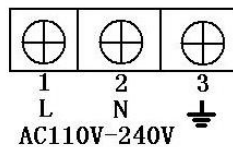

- Insert the power cable from the gland box and then connect them to the corresponding terminals inside the lamp body (please see above illustration).
- Check whether the power cables are connected correctly before power on.
- Close array and re attach the holding clips.

## ... Please Note...

- Temperature rise inside the control box is normal phenomenon
- Please do not open any components inside by yourself
- This product is a sealed structure and should not be tampered with by anyone other than registered installer.

**Please use this product strictly in accordance with the  
instructions above**

Delta Obstruction Lighting Ltd.  
Delta House  
Wrigley Street  
Oldham  
OL4 1SL  
U.K  
Tel:0044 (0) 161 7854940  
Fax:0044 (0) 161 7854941